



BIJOUMONTRE

SWISS MADE

USER MANUAL

CONTENTS

	Page
A. Introduction	2
B. International Warranty	2
C. Care & Maintenance	
- Batteries	3
- Other Recommendations	3
D. Setting	
- Quartz 2 Hands	
I. Around the World Models	5
II. Carat Diamond / Petite / Secret Garden Models	5
E. Changing the Components	
- World Charms (Middle Ring & Mother-of-Pearl Outer Ring) (Around the World Models)	6
- Secret Charm (Secret Garden Models)	8
- Strap and Metal Bracelet (Except Carat Diamond J045SSSSMW0)	9

A. INTRODUCTION

Thank you for choosing BIJOU MONTRE. You have acquired a delicate and precious watch which has a perfect balance of fine jewelry and exceptional Swiss craftsmanship.

B. INTERNATIONAL WARRANTY

Your BIJOU MONTRE is warranted for a period of two (2) years from the date of purchase under normal usage.

This international warranty covers manufacturing workmanship and in limited liability.

The warranty does not cover the following:

- Battery life;
- Aesthetic parts, including case, crystal, bracelet or strap, buckle or clasp etc.;
- Any damages caused by accident, mishandling, negligence or improper use;
- Normal wear, tear and aging;
- Your BIJOU MONTRE has been handled or repaired by unauthorized persons.

If your BIJOU MONTRE needs service or repair, we recommend you to find the service centre addresses from our official website and bring it along with a valid warranty card to your nearest official BIJOU MONTRE service centre or contact us. The warranty card must be completed and stamped by the authorized BIJOU MONTRE dealer where you bought your watch on the date of purchase. The card must bear the model no., serial no., shop name and date of purchase.

Please be noted that a fee may apply for repair beyond warranty coverage or period.

C. CARE & MAINTENANCE

Batteries

The battery in BIJOUMONTRE quartz watch can normally last for two (2) years. If you find that your watch is inaccurate or even non-functional, we recommend you to take it to the nearest official BIJOUMONTRE service centre for replacing the battery. When the battery is replaced at an authorized BIJOUMONTRE service centre, the battery life is warranted for a period of one (1) year from the date of battery replacement.

Avoid leaving a flat/drained battery in your BIJOUMONTRE quartz watch for a long time as it may leak and damage the movement.

Other Recommendations



Magnetic Fields

Avoid putting near any materials which create powerful magnetic fields, such as mobile phone, refrigerator, speaker, television set, cable box, magnetic clasp on handbag etc.



Impact

Avoid knocking against any objects.



Extreme Conditions

Avoid exposing in extremely warm or cold places or under sudden change in humidity condition.

C. CARE & MAINTENANCE



Chemicals

Avoid contacting directly with cosmetic, perfume, detergent or solvent, as those constituents may damage the case, bracelet or strap.



Cleaning

Clean with a soft cloth only. After contacted with salt water, you may gently rinse it under tap water and wipe it dry with a soft cloth.



Leather Strap

Avoid contacting with water. If your leather strap got wet, we recommend you to put it in a dry place to prevent deterioration.



Water Resistance

Apart from date and time setting, the crown must be pushed back against the case to preserve water resistance.

D. SETTING

Quartz 2 Hands - Electro Setting (Around the World Models)

To showcase extraordinary aesthetics of the entire timepiece, this model has push-piece.

Time Setting

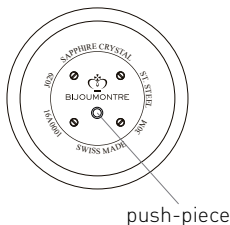

- I. Adjust the time by using the attached pin to press the push-piece in the centre of the caseback.
- II. Press for two (2) seconds, minute hand will move forward for one (1) minute.
- III. Press for two (2) to four (4) seconds, hour hand will move forward for one (1) hour.
- IV. Continuously pressing the push-piece for more than four (4) seconds for quick setting, all hands will move forward until release.

Quartz 2 Hands (Carat Diamond/Petite/Secret Garden Models)

Time Setting

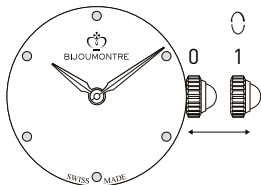

- I. Pull out the crown to position 1, all hands will stop.
- II. Turn the crown clockwise (forward) or counterclockwise (backward) to set the time.
- III. When the correct setting appears on the display, push the crown back to position 0. The watch will operate normally.

E. CHANGING THE COMPONENTS

World Charms (Middle Ring & Mother-of-Pearl Outer Ring) (Around the World Models)

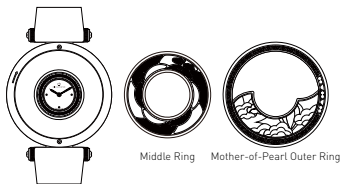

Your watch is equipped with changeable world charms (middle ring & Mother-of-Pearl outer ring).



1

Turn the Mother-of-Pearl outer ring counterclockwise about 90° to loosen it. Take off the outer ring first before changing the middle ring.

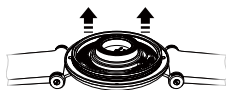

2

Remove the middle ring perpendicularly upwards.

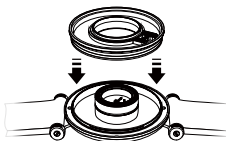

3

Insert another middle ring perpendicularly on the case.

E. CHANGING THE COMPONENTS

World Charms (Middle Ring & Mother-of-Pearl Outer Ring) (Around the World Models)

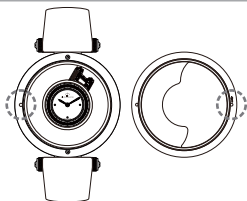

4

Put back the Mother-of-Pearl outer ring by aligning the arrows on the case at 9H position.



5

Turn the outer ring clockwise about 90° to lock it.

E. CHANGING THE COMPONENTS

Secret Charm (Secret Garden Models)



secret charm

Your watch is equipped with a changeable secret charm.



1

Press down the secret charm to unlock it.

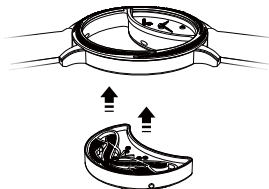

2

Change to another secret charm by pushing it back to the case to lock it.

E. CHANGING THE COMPONENTS

Strap and Metal Bracelet (Except Carat Diamond J045SSSSMW0)

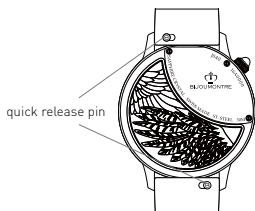

Your watch is equipped with quick release pin for strap and metal bracelet changing.



1

When the strap or metal bracelet is at 6H position, slide and hold the quick release pin head to the left. Pull the strap or metal bracelet down to remove it.



2

Position and engage quick release pin to the spring bar hole.



3

Slide the pin head to the left to engage fully.